

**OFFICER DELEGATION SCHEME
RECORD OF OPERATIONAL DECISION**



TO BE UPLOADED TO THE E-MEETINGS MANAGER

Date: 12.06.17	Ref No: 2640	
Type of Operational Decision:		
Executive Decision	<input checked="" type="checkbox"/>	Council Decision
Status: For publication		
Title/Subject matter: Bury Agricultural Show at Burrs Country Park - Temporary Prohibition of Waiting, Woodhill Road, Hunstanton Drive and Brandlesholme Road, Bury		
Budget/Strategy/Policy/Compliance - Is the decision:		
(i) within an Approved Budget	✓	
(ii) not in conflict with Council Policy	✓	
(iii) not raising new issues of Policy	✓	
Equality Analysis [Does this decision change or make policy; change or make procedure or working practice? An Equality Analysis must be completed to assess the impact on equality and the relevance of the Public Sector Equality Duty. This should be signed off by your departmental equality representative and accompany this decision form. Please forward a copy to the Equality email for publication].	No	
	Signed: (By EA Officer)	Date:
Details of Operational Decision Taken [with reasons]:		
Approval to the temporary traffic regulation order (no waiting at any time) under Section 14(2) of the Road Traffic Regulation Act 1984 on Woodhill Drive, Hunstanton Drive and Brandlesholme Road, Bury on Sunday 25 June 2017 for a period of one day (7am - 7pm) to facilitate vehicular access to and from Bury Agricultural Show Event at Burrs Country Park.		
Decision taken by:	Signature:	Date:
D R Giblin Head of Engineering		13/06/17
Members Consulted [see note 1 below]		
Cabinet Member/Chair		
Lead Member		
Opposition Spokesperson		

Notes

1. It is not generally a requirement to consult with any Members on Operational Decisions but where an Executive Director considers it necessary to consult with the appropriate Cabinet Member and/or Lead Member, they must sign the form so as to confirm that they have been consulted and that they agree with the proposed action. The signature of the Opposition Spokesperson should be obtained to confirm that he/she has been consulted.
2. **This form must not be used for urgent decisions.**

January 2015

**BURY COUNCIL
PROPOSED TEMPORARY TRAFFIC CONTROL BY NOTICE
ROAD TRAFFIC REGULATION ACT 1984 SECTION 14(2)**

<p>Name and Lengths of Road(s) Affected</p>	<p>Woodhill Road, Bury – westerly side from a point 15 metres south of Hunstanton Drive to a point 140 metres south of Hunstanton Drive</p> <p>Woodhill Road, Bury – easterly side from its junction with Brandlesholme Road to a point opposite 34 metres north of the northerly kerbline of Hunstanton Drive</p> <p>Woodhill Road, Bury – north easterly side from opposite a point 94 metres north of the northerly kerbline of Hunstanton Drive in a north westerly direction to Stock Street</p> <p>Woodhill Road, Bury – north easterly side from a point 11.6 metres northwest of the westerly kerbline of Stock Street to a point 190 metres northwest of the westerly kerbline of Stock Street</p> <p>Woodhill Road, Bury – north westerly side from Brandlesholme Road to a point 33 metres east of Brandlesholme Road</p> <p>Hunstanton Drive, Bury – northerly side from a point 12 metres west of the westerly kerbline of Woodhill Road to Brandlesholme Road</p> <p>Hunstanton Drive, Bury – southerly side from Brandlesholme Road to a point 20 metres east of Brandlesholme Road</p> <p>Brandlesholme Road, Bury – easterly side from a point 25 metres south of the southerly kerbline of Hunstanton Drive to a point 25 metres north of the northerly kerbline of Hunstanton Drive.</p>
<p>Reason for Notice/Order</p>	<p>To facilitate vehicular access to and from the Bury Agricultural Show Event at Burrs Country Park.</p>
<p>Nature of Notice/Order</p>	<p>Temporary Prohibition of Waiting Order</p>
<p>Period of Notice/Order</p>	<p>1 day</p>
<p>Date of Commencement of Notice/Order</p>	<p>Sunday 25 June 2017</p>
<p>Anticipated Duration of Works</p>	<p>1 day (approximately between 7am and 7pm)</p>
<p>Is the Emergency Procedure being invoked?</p>	<p>YES/NO Note: For an unforeseen crisis a road may be closed for up to 21 days</p>
<p>Is a Temporary Order to be made?</p>	<p>YES/NO</p>
<p>Description of Alternative</p>	<p>N/A</p>

Route(s)																
Have Notices been Posted?	YES/NO															
Name of Person to be Contacted for Further Information.	Katie Mercer Tel: 0161-253-5832															
Emergency Closures - Have the following been informed?	<table> <tr> <td>Police</td> <td>YES/NO</td> <td></td> </tr> <tr> <td>Fire</td> <td>YES/NO</td> <td>NOT</td> </tr> <tr> <td>Ambulance</td> <td>YES/NO</td> <td>APPLICABLE</td> </tr> <tr> <td>P.T.E.</td> <td>YES/NO</td> <td></td> </tr> <tr> <td>Streetworks</td> <td>YES/NO</td> <td></td> </tr> </table>	Police	YES/NO		Fire	YES/NO	NOT	Ambulance	YES/NO	APPLICABLE	P.T.E.	YES/NO		Streetworks	YES/NO	
Police	YES/NO															
Fire	YES/NO	NOT														
Ambulance	YES/NO	APPLICABLE														
P.T.E.	YES/NO															
Streetworks	YES/NO															
Recharge Code	465 HAM4000 5641 TRT															

Engineering Manager

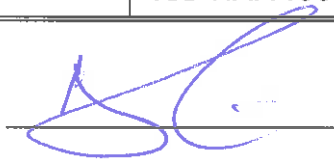

Date

13/06/17

Delegated Powers Form Ref No

METROPOLITAN BOROUGH OF BURY

**ROAD TRAFFIC REGULATION ACT 1984, SECTION 14(2)
THE METROPOLITAN BOROUGH OF BURY
(WOODHILL DRIVE, HUNSTANTON DRIVE AND BRANDLESHOLME ROAD, BURY,
BURY AGRICULTURAL SHOW AT BURRS COUNTRY PARK)
TEMPORARY CLOSURE NOTICE 2017**

NOTICE IS HEREBY GIVEN that under the provisions of Section 14(2) of the Road Traffic Regulation Act, 1984, vehicular traffic is prohibited from waiting at any time in the following length(s) of highway:

Woodhill Road, Bury – westerly side from a point 15 metres south of Hunstanton Drive to a point 140 metres south of Hunstanton Drive

Woodhill Road, Bury – easterly side from its junction with Brandlesholme Road to a point opposite 34 metres north of the northerly kerblines of Hunstanton Drive

Woodhill Road, Bury – north easterly side from opposite a point 94 metres north of the northerly kerblines of Hunstanton Drive in a north westerly direction to Stock Street

Woodhill Road, Bury – north easterly side from a point 11.6 metres northwest of the westerly kerblines of Stock Street to a point 190 metres northwest of the westerly kerblines of Stock Street

Woodhill Road, Bury – north westerly side from Brandlesholme Road to a point 33 metres east of Brandlesholme Road

Hunstanton Drive, Bury – northerly side from a point 12 metres west of the westerly kerblines of Woodhill Road to Brandlesholme Road

Hunstanton Drive, Bury – southerly side from Brandlesholme Road to a point 20 metres east of Brandlesholme Road

Brandlesholme Road, Bury – easterly side from a point 25 metres south of the southerly kerblines of Hunstanton Drive to a point 25 metres north of the northerly kerblines of Hunstanton Drive

Nothing in this notice will apply to emergency vehicles, and any vehicle engaged in the implementation, removal or enforcement of the restrictions introduced pursuant to this notice.

The reason for the proposed order is to facilitate vehicular access to and from the Bury Agricultural Show Event at Burrs Country Park.

The notice will come into operation on Sunday 25 June 2017 and last for a maximum of 5 days only.

Dated 12 June 2017

Bury Agricultural Show Temporary Prohibition of Waiting

KEY:

- Temporary Prohibition of Waiting
- Permanent No Waiting at Any time restrictions in place

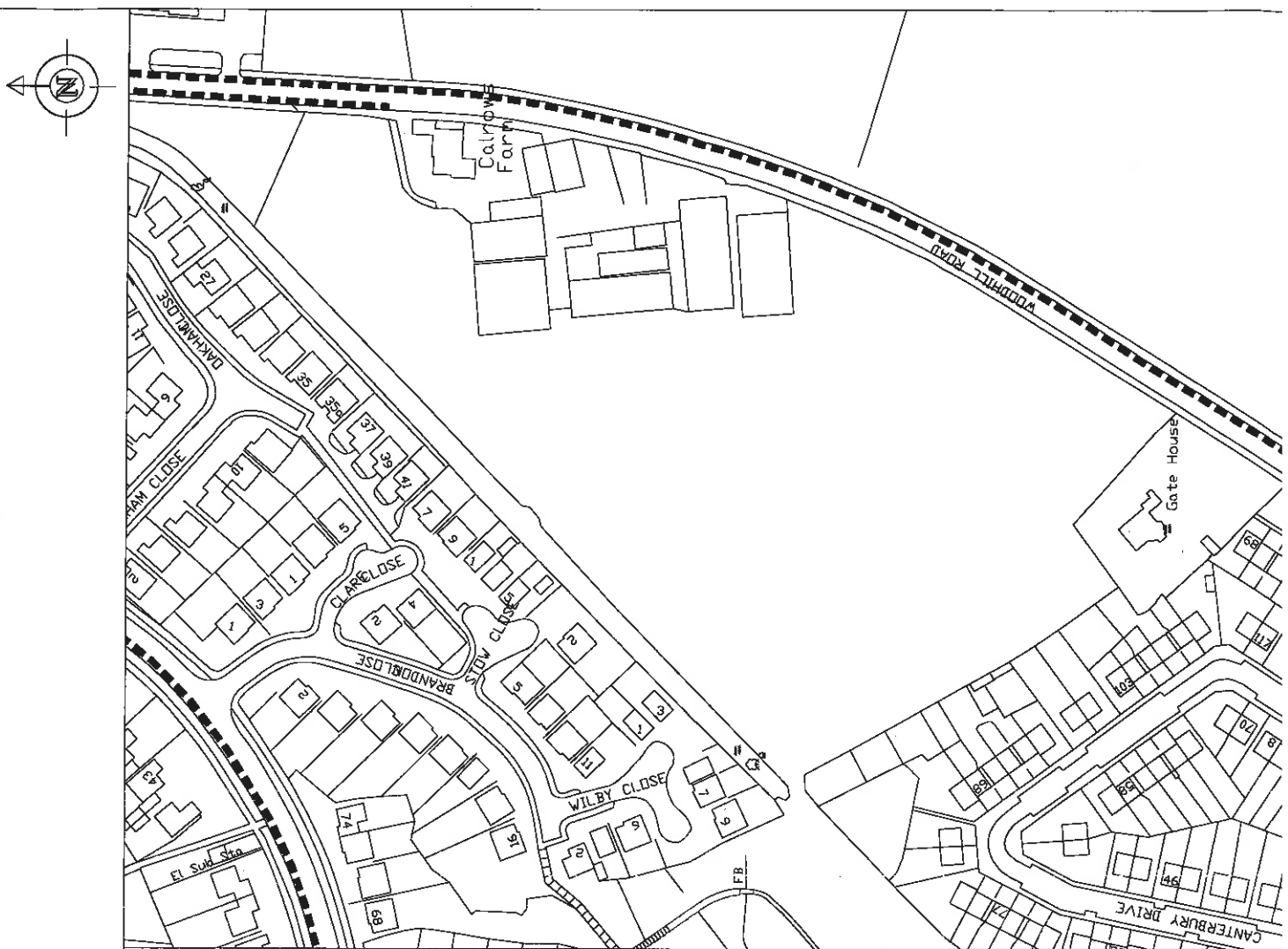
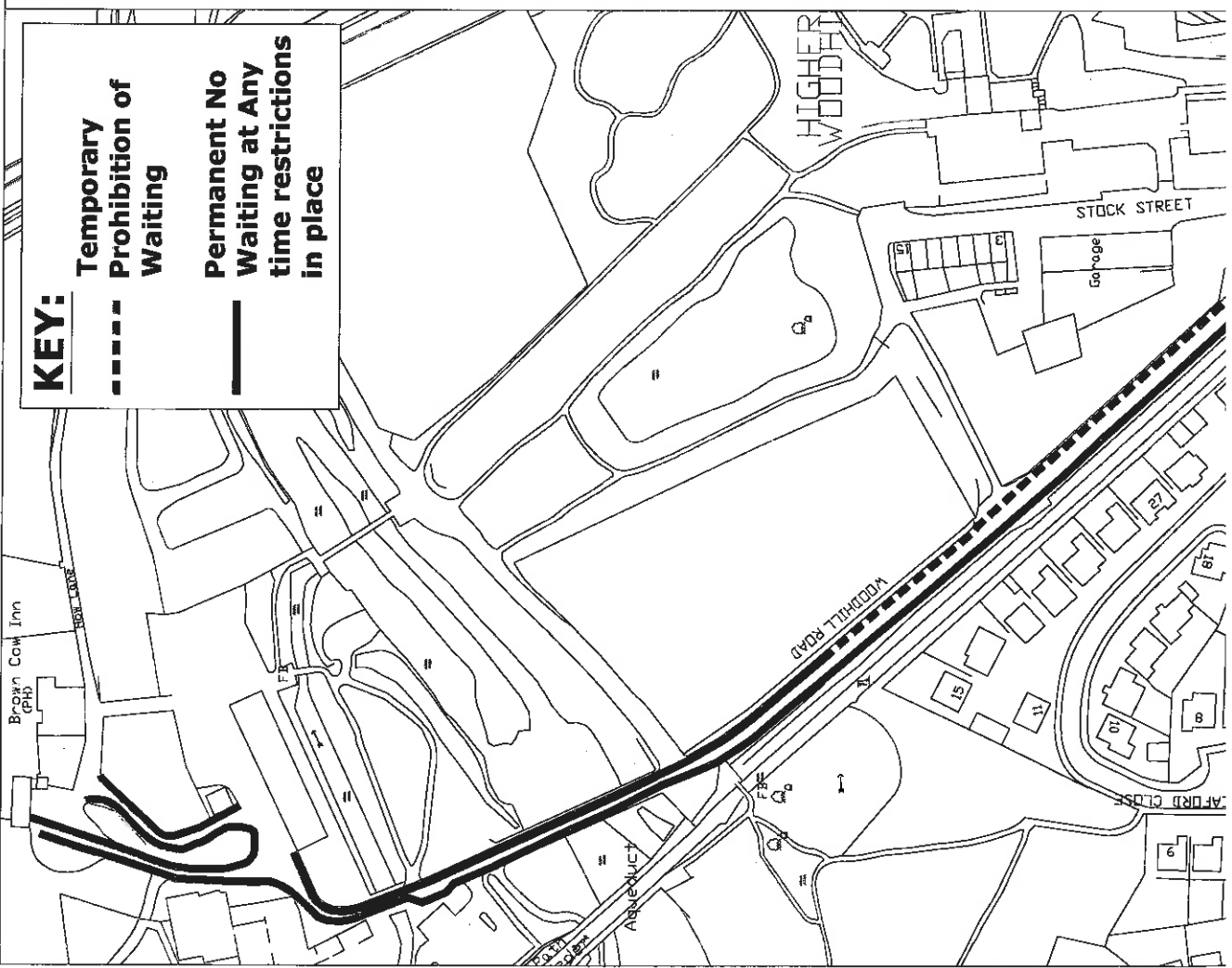

Bury Agricultural Show Temporary Prohibition of Waiting

KEY:

- Temporary Prohibition of Waiting

